

# EAST MIDLANDS CONFERENCE CENTRE

## GROUND FLOOR PLAN

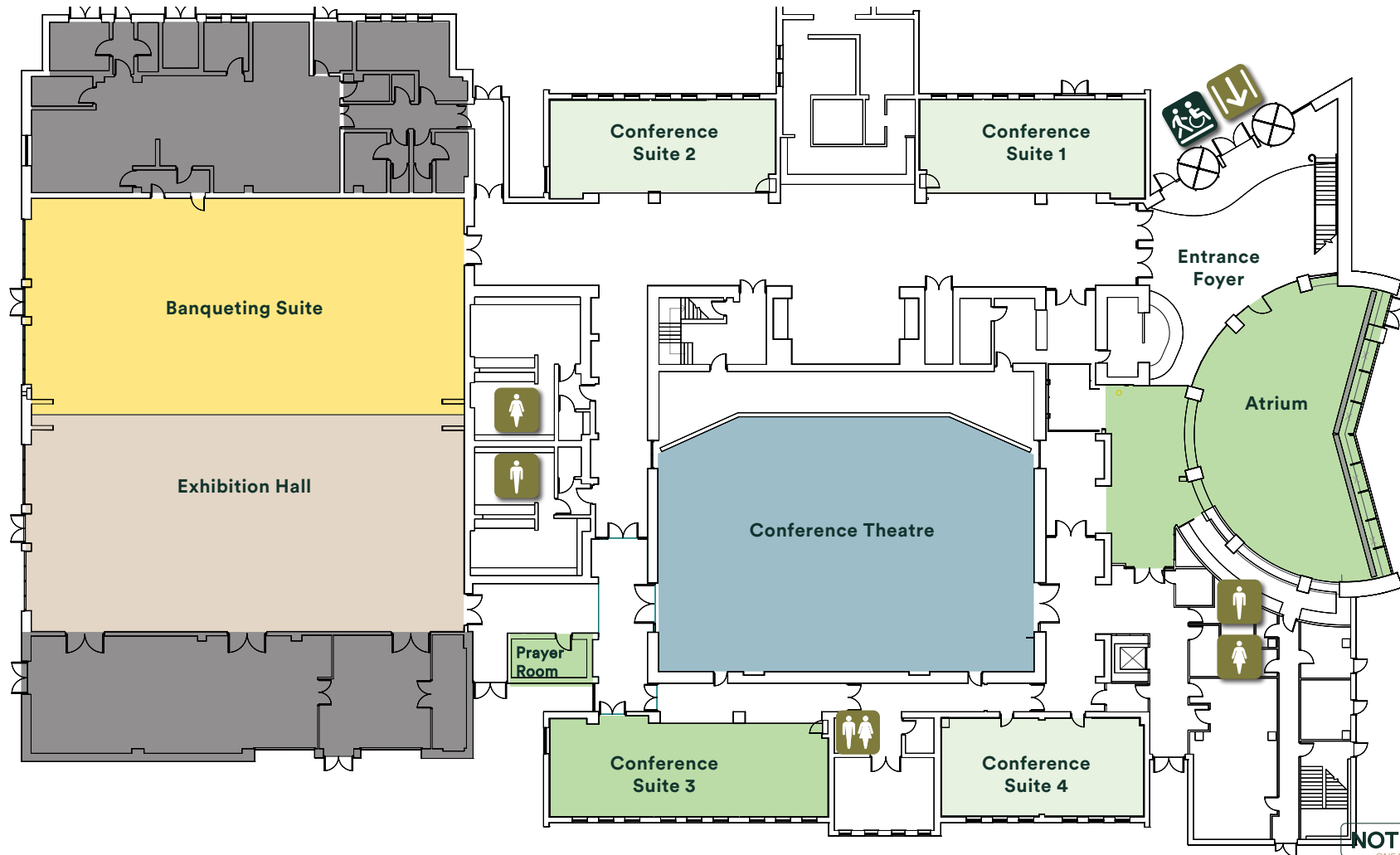

**NOTTINGHAM VENUES**  
ONE DESTINATION • ENDLESS POSSIBILITIES

### Room Specs

**Conference Theatre**  
22.4m(W) x 13.7m(L) x  
7.4m(H) 296m<sup>2</sup> total area

**Banqueting Suite**  
25.9m(W) x 25.9m(L) x  
4.1m(H) 670m<sup>2</sup> total area

**Exhibition Hall**  
25.9m(W) x 25.9m(L) x  
4.1m(H) 670m<sup>2</sup> total area

**Conference Suite 1**  
13.2m(W) x 5.9m(L) x 3m(H)  
77m<sup>2</sup> total area

**Conference Suite 2**  
13.2m(W) x 5.8m(L) x 3m(H)  
76m<sup>2</sup> total area

**Conference Suite 3**  
16.5m(W) x 5.9m(L) x 3m(H)  
96m<sup>2</sup> total area

**Conference Suite 4**  
12m(W) x 5.8m(L) x 2.8m(H)  
70m<sup>2</sup> total area

- Atrium
- Conference Suite 1,2,3 & 4
- Exhibition Hall
- Banqueting Suite
- Conference Theatre
- Restricted Areas
- Entrance
- Prayer Room
- Toilets (Male/Female)
- Accessible Entrance
- Gender Neutral Toilet